

ZHT-1313L/S Tubular Solenoid

ISO/TS16949 ISO9000 ISO14000
RoHS REACH CE UL VDE TÜV

类型: 推式 TYPE: PUSH

滑杆外部与负载连接的典型结构
plunger type:

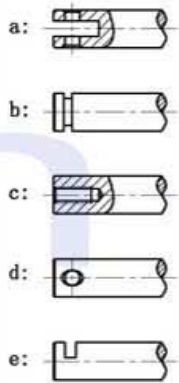

顶杆外部与负载连接的典型结构
push shaft type:

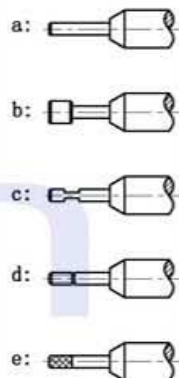

总重量 Total Weight: 14g
应用范围: 用于测试机, 钢琴等
APPLICATION: TEST MACHINE, PIANO

安匝/吸引力
AMPERE-TURNS Vs FORCE

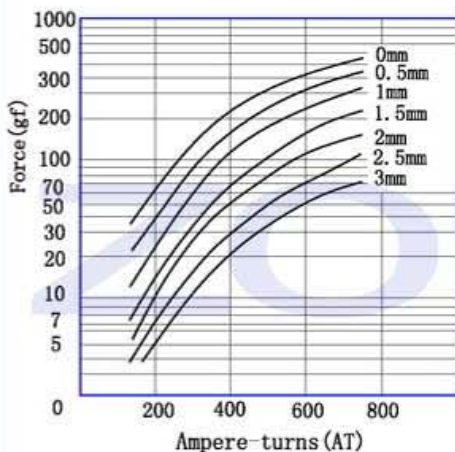

行程/吸引力
STROKE Vs FORCE

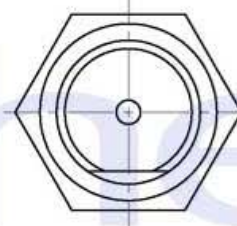
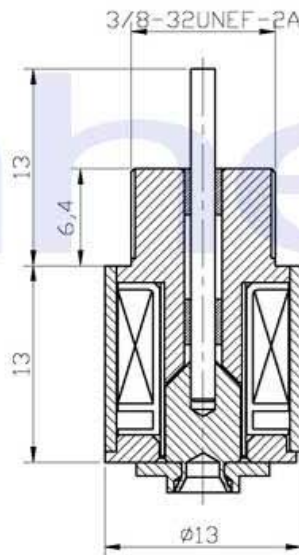
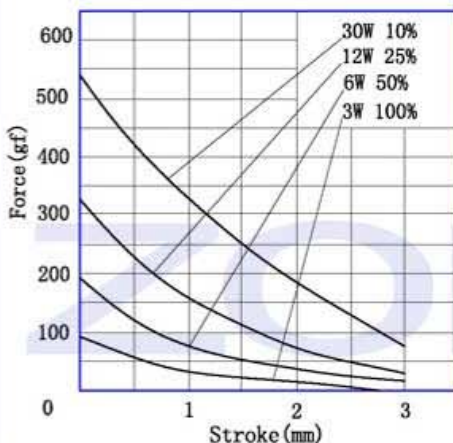

单位:mm Units:mm 通电状态 Shown Energized

COIL DATA线圈资料

工作周期(%) = $\frac{\text{工作时间}}{\text{工作时间} + \text{断开时间}} \times 100\%$ Duty cycle(%) = $\frac{\text{"ON" time}}{\text{"ON" time} + \text{"OFF" time}} \times 100\%$	连续 Continuous 100%	间断 Or less 50%	间断 Or less 25%	间断 Or less 10%
最大工作时间(秒) MAX. "on" time in seconds	∞	50	18	3
瓦特(W) (20°C) Watts at 20°C	3	6	12	30
安匝数AT(20°C) Ampere-turns at 20°C	225	292	403	640

型号 Type no.	阻值(20°C) Resistance (Ω) ±10%	线圈匝数 No. Turns	电压(VDC) VoltS DC			
ZHT-1313L-XX A XX	12	450	6	8.5	12	19
	48	824	12	17	24	38
	192	1611	24	34	48	76
	768	3235	48	68	96	152